

HOKULANI



HOKULANI

Hull No. 1 of the PJ150 series from American shipyard Palmer Johnson, 46m HOKULANI is a wonder of her own. Maintained in perfect condition by her professional and attentive crew since her launch in 2007, HOKULANI is certainly the best in class. No other PJ150 superyacht available on the market or similar yacht have had the upgrades, improvements or care that HOKULANI has had. Offering accommodation for up to 10 guests in 5 staterooms plus quarters for 7 crew members, HOKULANI ensures the best quality time on board.

Her champagne coloured Hull & superstructure, designed by Palmer Johnson in collaboration with Bugatti along with the talent of Nuvolari Lenard studio, have engineered traits such as the accentuated centre line, perfect symmetry and sweeping curves adding to her already very sporty attitude. Revolutionary in her style at the time, and still accurate today, HOKULANI features some bright exterior functionality such as her wide and social Main deck with sun lounge area and dining, or her Sun deck with a large a glass atrium roof panel that slides fore & aft: you can choose to cruise either in the sun or in the shade! Further uses of space include a custom swim platform with a self-deploying ladder and a hydraulically powered tender garage able to welcome a large tender and additional jet skis and water toys.

The perfect condition of HOKULANI is reflected in the quality of her interiors: her new dark wooden floors achieved in 2019 are perfectly matching with the neutral and bright atmosphere, enhanced by large windows throughout the Main deck salon, which also includes a dining area for 10 to 12 guests. Following a large corridor is the access to the Cinema room with brand new audio/video system also achieved in 2019, and private access to the full-beam en-suite Master cabin, including a lobby with a walk-in wardrobe, a king-sized bed with a study area to starboard, a fully-equipped bathroom and a seating area to port. Four additional cabins are available on board, with two VIP cabins with double beds and two Twin cabins with 2 x single beds. All Guest cabins have en-suite facilities.

On the Crew side, HOKULANI offers first a sleek raised bridge which has masterfully fused fashion and function, also refitted in 2019 with new upholstery. The Crew Mess / Galley area is fully functional and social to ensure the wellness of the crew, with direct access to the accommodation for up to 7 members. Powered by twin responsive MTU diesel engines, this head turning sports cruiser can accelerate to a rousing speed underway of 26 knots. The engine creates 3,650 horse power (2,723 kilowatts), for a total HP of 7,300HP (5,446kW). In addition, HOKULANI is one of the only superyacht of this style with zero speed fin stabilizers.

















DECKS











INTERIOR



















SPECIFICATION

- 1 SUN DECK AFT
- 2 SUN DECK LOUNGE
- 3 BRIDGE
- 4 FORE DECK LOUNGE
- 5 SWIM PLATFORM
- 6 SUNBATHING AREA
- 7 MAIN DECK AFT
- 8 MAIN DECK AFT - DINNING AREA
- 9 MAIN DECK SALON
- 10 MAIN DECK DINNING
- 11 STAIRS TO BRIDGE
- 12 STAIRS TO GUEST CABINS
- 13 STAIRS TO MASTER CABIN
- 14 CINEMA ROOM
- 15 CREW AREA (CREW MESS+ GALLEY)
- 16 LAZARETTE
- 17 ENGINE ROOM
- 18 DOUBLE CABIN
- 19 DOUBLE CABIN
- 20 TWIN CABIN
- 21 TWIN CABIN
- 22 FULL-BEAM MASTER CABIN
- 23 CREW ACCOMODATION

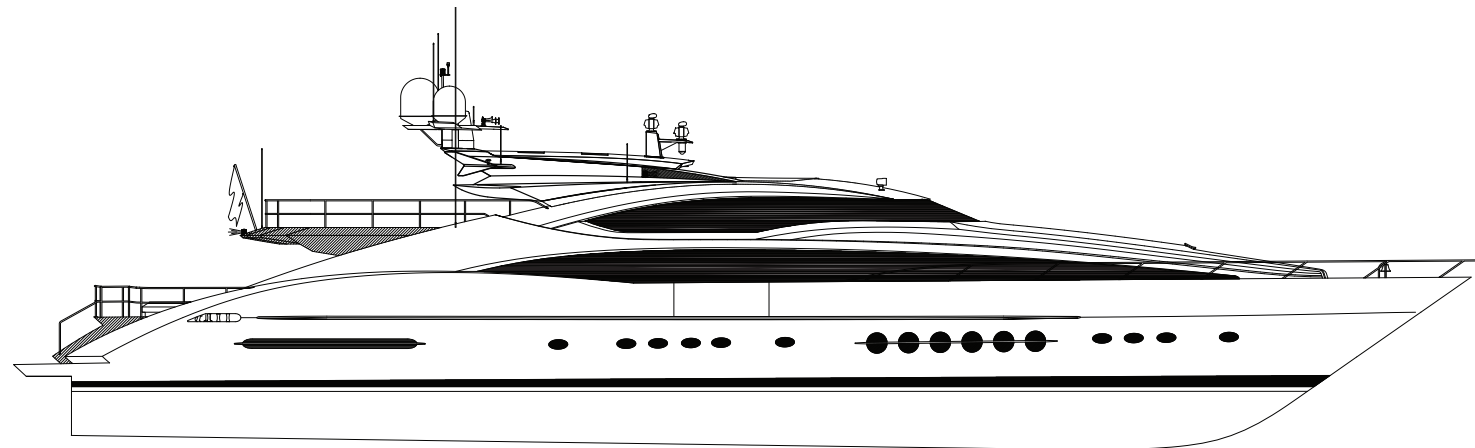

PROFILE

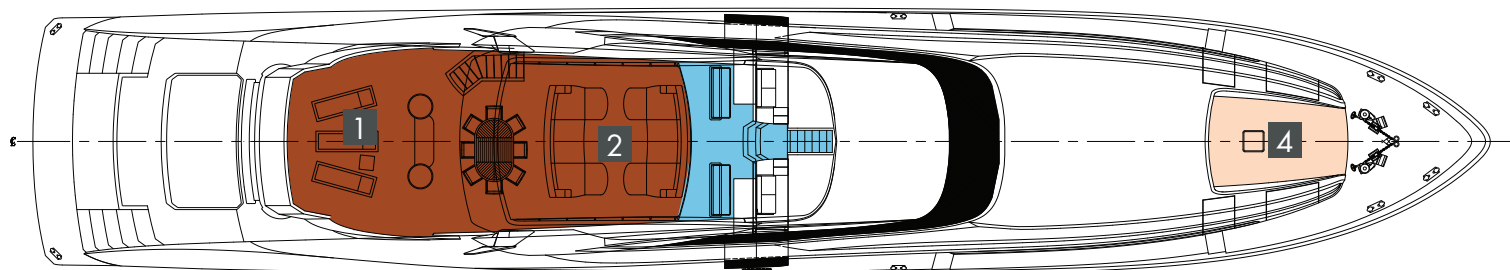

SUN DECK

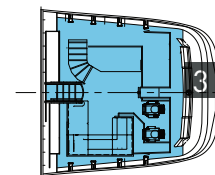

BRIDGE

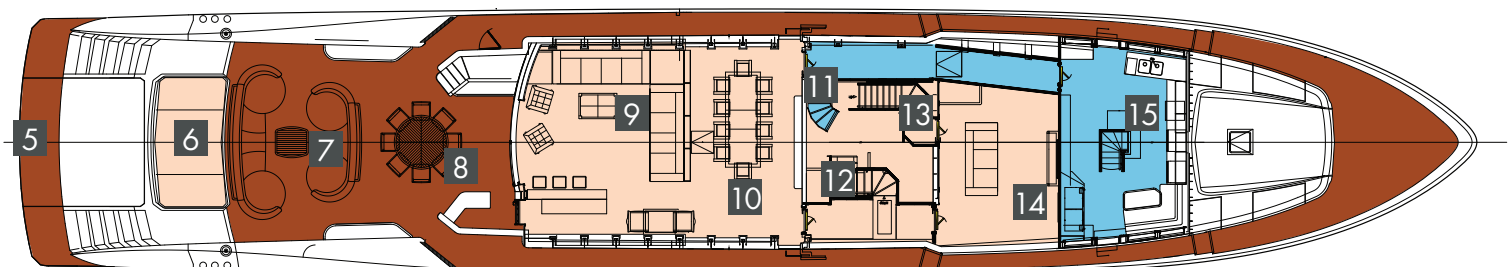

MAIN DECK

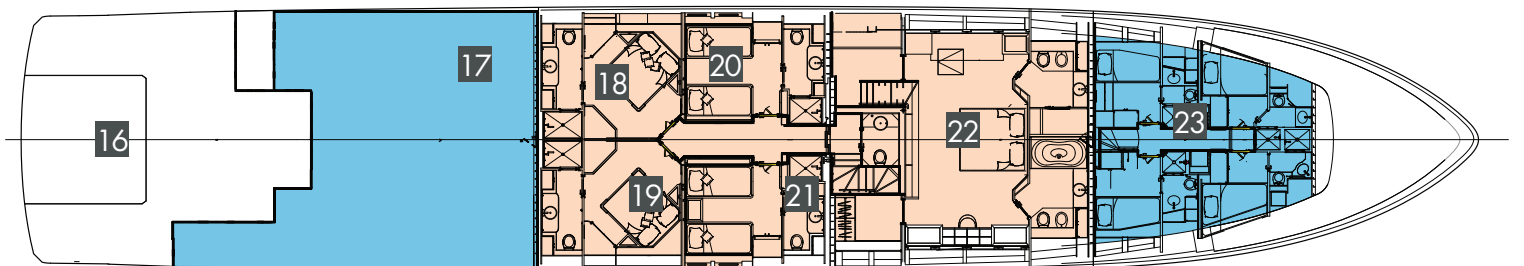

LOWER DECK

Shipyard	Palmer Johnson
Model	PJ150
Delivery Year	2007
Exterior Designer	Nuvolari Lenard
Interior Designer	Nuvolari Lenard
Length overall	45.7m
Length waterline	41.2m
Beam	8.4m
Draft (full load)	1.9m
Construction	Aluminum
Gross Tonnage (GT)	380GT
Flag	Cayman Island
Guests (cruising)	12
Guests (sleeping)	10
Crew	7
Maximum Speed	26kn
Cruising Speed	20kn
Range (cruising speed)	2,500NM @ 12kn
Main engines	MTU 16V 4000 M90 series, 2 x 3,650 HP
Generators	2 x 70kW Kohler
Stabilisers	4 X Seakeeper 21000 and 2 x Fins ABT Trac Zero Speed
Bow thruster	ABT / TRAC 20

Fuel capacity	41,000 L
Fresh water capacity	5,700 L
Classification	LLOYDS 100A1 SSC Yacht

Additional Information	<ul style="list-style-type: none"> • 10-years Lloyds survey done in 2018 • Full painting applied in July 2018 • New interior floor and AV/IT refit done in 2019
------------------------	--

Guest Accommodation	<p>5 en-suite cabins all located on Lower deck divided as:</p> <ul style="list-style-type: none"> • Full-beam Master with office, bathroom and walk-in dressing, privately accessible from the Cinema room on Main deck • 2 x VIP cabin with double beds • 2 x Twin cabin with double beds
---------------------	---

Tenders	Castoldi 18'
Water Sports Equipment	<ul style="list-style-type: none"> • 1 x Kawasaki Jet Ski • 2 x Seabobs F5SR

Communications	<ul style="list-style-type: none"> • 1 x Ka Skytech Antenna, • 2 x Ku Seatel Antenna, • 4G and 5G ready
----------------	--

Entertainment	Crestron system (Audio-Video system refitted in 2019)
---------------	---

The particulars are believed to be correct but are not guaranteed and may not be used for contractual purposes. - Specification provided for information only.





